

200A , 15 kV & 25 kV Class Loadbreak Grounding Bushing



APPLICATION

The Chardon grounding bushing grounds disconnected cables during maintenance to protect personnel. The interface is designed to IEEE 386 and mates with any compliant 15 or 25 kV 200 A loadbreak elbow. The body is molded from EPDM rubber.

Each kit ships preassembled with a grounding cable, a copper compression lug, and a grounding clamp.

CURRENT RATINGS

Tests conducted in accordance with IEEE/ANSI Standard 386:

Current Tests	Amperes
Short Time	10,000 A rms symmetrical for 0.17s

Tests conducted in accordance with Chardon manufacturing process requirements:

- / Physical Inspection
- / Periodic Dissection
- / Periodic X-ray Analysis

ORDERING INFORMATION

Each kit Contains:

- / Grounding Bushing
- / Shipping Cap
- / Silicone Grease
- / Installation Instruction Sheet

Deadbreak Grounded Standoff Bushing

Part Number	Description
15-GB200	15 kV, 200A Grounding Bushing
15-GB200CK	25 kV, 200A Grounding Bushing w/ Clamp
25-GB200	15 kV, 200A Grounding Bushing
25-GB200CK	25 kV, 200A Grounding Bushing w/ Clamp

TECHNICAL DRAWINGS

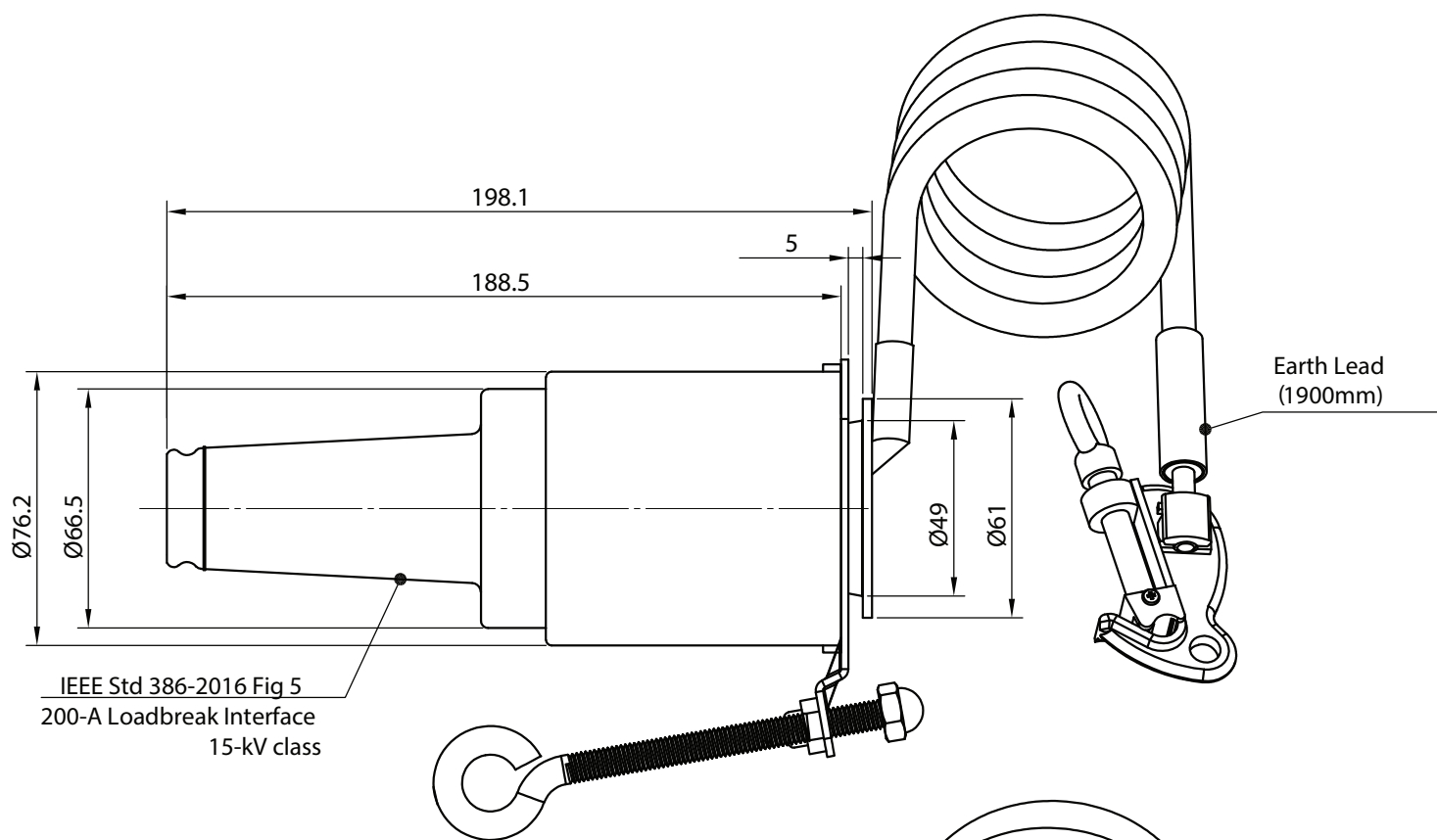

15-GB200CK

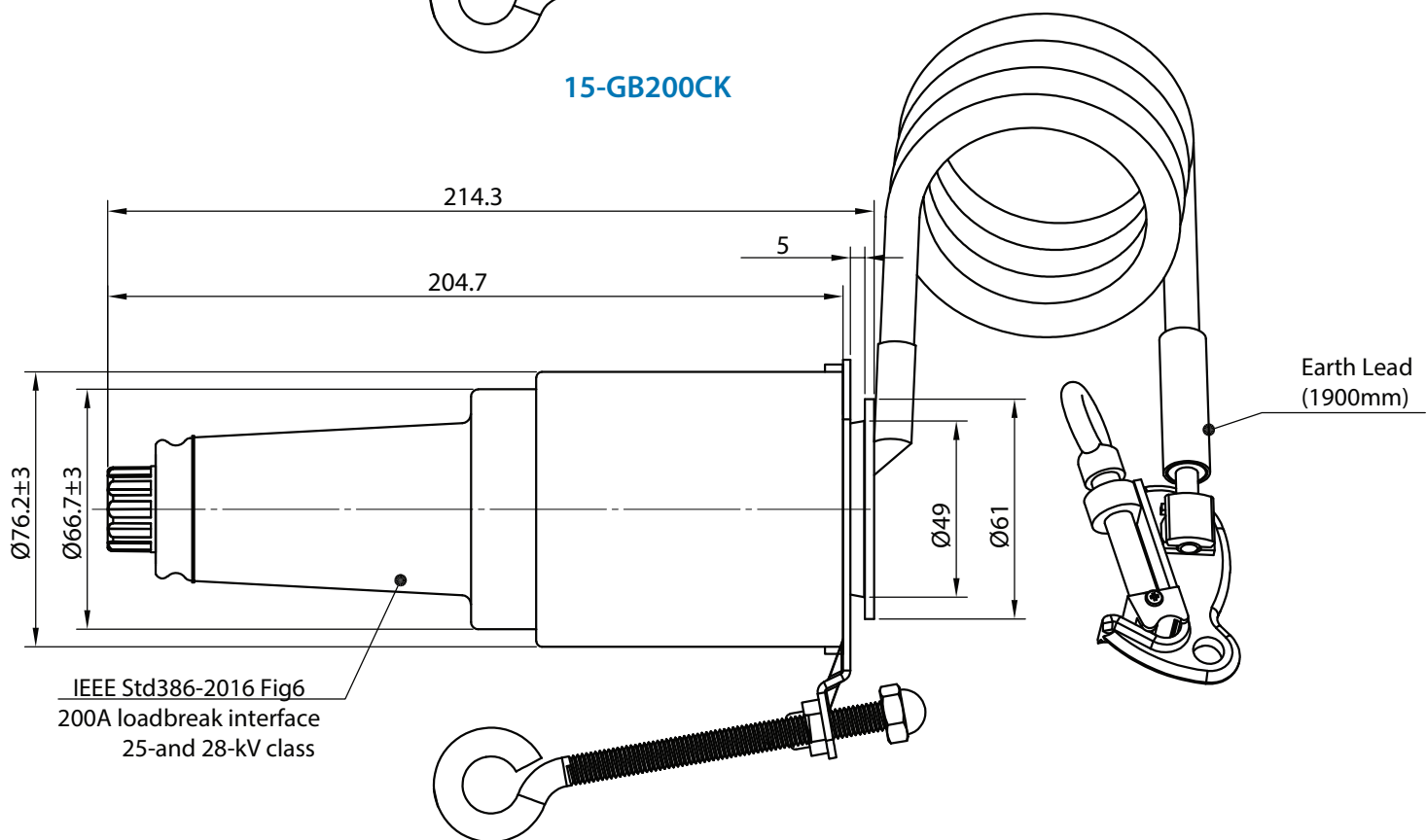

25-GB200CK



ANHUI CHARDON ELECTRIC LTD.

No.808 Taiji Road Economic Develop Zone of Guangde
County Anhui China

Tel: 0563-2216688

Fax: 0563-2251806

CHARDON TAIWAN CORPORATION

No.37 Min-Chie Road, Tung Lo Industrial Park, Miao Li,
Taiwan 366

Tel: +886-37-984385

Fax: +886-37-984770

SHANGHAI CHARDON ELECTRIC LTD.

Room 1202, office building No.399, Yun Gu Road ,
Jiading district, Shanghai, China 201801

Tel: +86-21-39105900

Fax: +86-21-391059166

www.chardongroup.com info@chardongroup.com