

600A/900A 35kV Class Deadbreak Junction



APPLICATION

The Chardon 600A/900A, 35 kV Class Deadbreak Junction provides two, three or four deadbreak interfaces in an EPDM insulated rubber body. Deadbreak junctions are used in pad-mounted apparatus, underground vaults, and other installations to connect equipment and cable on primary feeder and network circuits.

Chardon deadbreak connectors feature bolted connections can be easily connected and disconnected. When mated with a comparably rated product, the junction provides a

fully shielded, submersible connection for deadbreak operation. The deadbreak junction is available with stainless steel adjustable brackets for mounting at various operating angles, or with stainless steel "U" straps for direct wall mounting.

Chardon deadbreak junctions are rated 900A continuous when copper components are used. To order a 900A product, please see the part number list in page 2.

PRODUCTION TESTS

Tests conducted in accordance with IEEE/ANSI Standard 386™:

- / AC 60 Hz 1 Minute Withstand – 50kV
- / Partial Discharge – 26 kV≤5pC

Tests conducted in accordance with Chardon requirements:

- / Physical Inspection
- / Periodic Dissection
- / Periodic Fluoroscopic Analysis

VOLTAGE RATINGS AND CHARACTERISTICS

Voltage Class	35 kV
Max. Rating Phase to Ground	21.1 kV
AC 1 Minute Withstand	50 kV
DC 15 Minute Withstand	103 kV
BIL and Full Wave Crest	200 kV
Partial Discharge	26 kV≤5pC

CURRENT RATINGS AND CHARACTERISTICS

Description	Amperes
Continuous	600 A rms
4 Hour Overload	1,000 A rms
Short Time	<ul style="list-style-type: none">• 25,000 A rms symmetrical for 0.17s• 10,000 A rms symmetrical for 3.0s

ORDERING INFORMATION

Each kit Contains:

- / Deadbreak Junction (with mounting bracket or straps, depending on product ordered)
- / Shipping Caps (not for energized operation)
- / Silicone Grease
- / Installation Instruction Sheet

Deadbreak Junction Part Numbers:

Description	Junction Only	Junction with Stainless Steel Bracket	Junction with U-Straps
35 kV ,600A Deadbreak Junction - 2Way (AL)	35-DJ600F2	35-DJ600F2SS	35-DJ600F2U
35 kV ,900A Deadbreak Junction - 2Way (CU)	35-DJ900F2	35-DJ900F2SS	35-DJ900F2U
35 kV ,600A Deadbreak Junction - 3Way (AL)	35-DJ600F3	35-DJ600F3SS	35-DJ600F3U
35 kV ,900A Deadbreak Junction - 3Way (CU)	35-DJ900F3	35-DJ900F3SS	35-DJ900F3U
35 kV ,600A Deadbreak Junction - 4Way (AL)	35-DJ600F4	35-DJ600F4SS	35-DJ600F4U
35 kV ,900A Deadbreak Junction - 4Way (CU)	35-DJ900F4	35-DJ900F4SS	35-DJ900F4U

* Chardon provides adjustable bracket, to order an adjustable bracket, add "ADJ" in the end of part numbers, for example, 35-DJ600F2SS-A D.

Replacement Parts

Description	Catalog Number
U-Strap kit with Hardware (1 strap)	35-DJ600U
Stainless Steel Bracket Assembly (2-way)	35-DJBKT2S
Stainless Steel Bracket Assembly (3-way)	35-DJBKT3S
Stainless Steel Bracket Assembly (4-way)	35-DJBKT4S

* 1 U-Strap for a 2 way junction, and 2 and 3 U-Straps for 3 or 4 way junctions.

JUNCTION WITH BRACKET

DIMENSIONAL INFORMATION

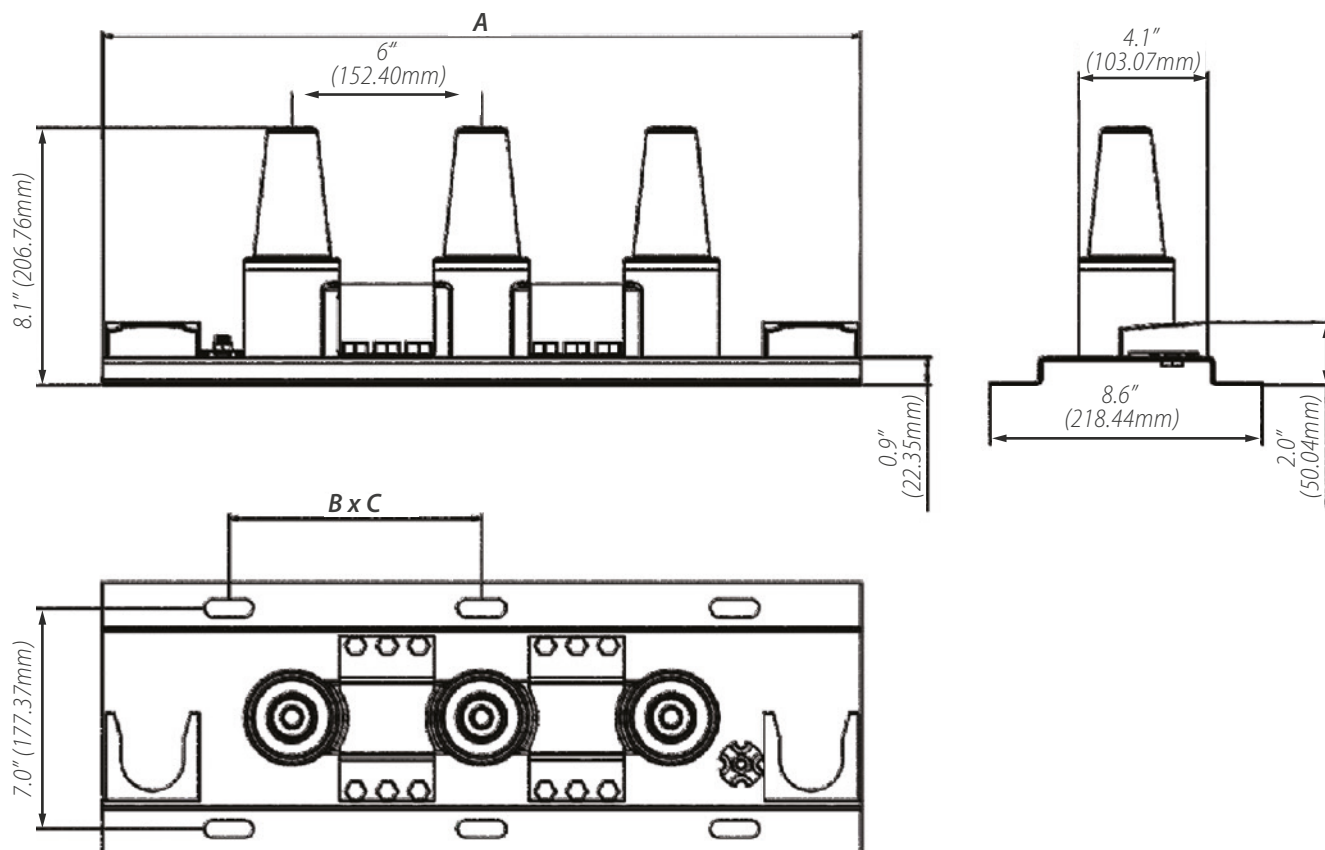

Dimensional Information

Number of Interfaces	Physical Dimensions in./mm		
	A	B	C
2-way	18.0 [457.2]	8.0 [203.2]	1
3-way	24.0 [609.6]	8.0 [203.2]	2
4-way	30.0 [762.0]	8.0 [203.2]	3

Configuration 1 : Both feet turned out.

Configuration 2 : One feet turned out , the other in.

Configuration 3 : Both feet turned in.

JUNCTION WITH U-STRAP DIMENSIONAL INFORMATION

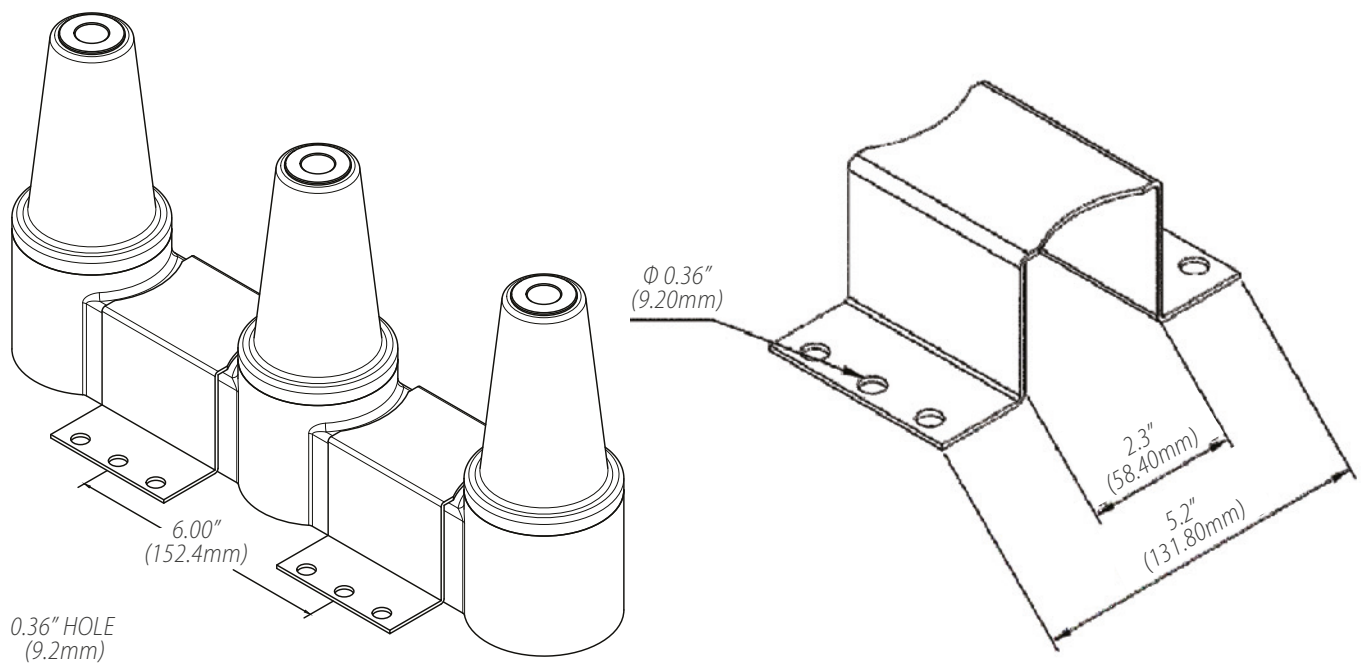



ANHUI CHARDON ELECTRIC LTD.

No.808 Taiji Road Economic Develop Zone of Guangde
County Anhui China

Tel: 0563-2216688

Fax: 0563-2251806

CHARDON TAIWAN CORPORATION

No.37 Min-Chie Road, Tung Lo Industrial Park, Miao Li,
Taiwan 366

Tel: +886-37-984385

Fax: +886-37-984770

SHANGHAI CHARDON ELECTRIC LTD.

Room 1202, office building No.399, Yun Gu Road ,
Jiading district, Shanghai, China 201801

Tel: +86-21-39105900

Fax: +86-21-391059166

www.chardongroup.com info@chardongroup.com