

## 200A BUSHING WELL WITH CLAMP INTEGRATED INSTALLATION & OPERATING INSTRUCTIONS

### DESCRIPTION:

The Chardon 200A Bushing Well with Clamp integrated meets all requirements of IEEE Standard 386, can be independently installed on the equipment without requiring additional Mounting Clamp. It is designed for the termination of primary winding leads at the face plate of oil filled (or approved equivalents) single phase and three phase transformers and switchgear.



### KIT CONTENT:

- Bushing Well with Shipping Cap
- Sealing O-Ring
- Instruction Sheet



### CAUTION:

- The installation of Chardon products must be carried out by qualified technical personnel.
- Contact with energized equipment can cause serious damage and even death.
- Wear appropriate protective equipment.
- Make sure Chardon Accessories are completely dry and in good condition at the time of installation.



### DANGER:

- Do not touch or handle energized products without adequate protective equipment. Errors in the compliance of this instruction can result in damage to the product, serious injuries to people and even death.
- All associated equipment must be de-energized during installation and maintenance.
- The following instructions do not cover details or variables in the change / installation of the product, to prevent contingencies, please contact the team of Chardon technicians if required.

### SAFETY INFORMATION

The instructions in this manual are not intended as a substitute for proper training or adequate experience in the safe operation of the equipment described. Only competent technicians who are familiar with this equipment should install, operate and service it.

### Warranty

Chardon products are guaranteed for a period of 2 years after their date of purchase, to make this guarantee effective you can come only by presenting a purchase invoice to your authorized Chardon distributor. The warranty will not be valid in the following cases:

1. When the product has been used under conditions other than normal.
2. When the product has not been operated according to the instructions for use.
3. When the product has been altered or repaired by persons not authorized by Chardon.
4. When using components that are not compatible with Chardon accessories.

Inasmuch as CHARDON GROUP, Inc. has no control over the use which others may put the material, it does not guarantee that the same results as those described herein will be obtained, each user of the material should make his own tests to determine the material's suitability for his own particular use. Statements concerning possible uses of the materials described herein are not to be construed as constituting a license under any CHARDON GROUP, inc. patent covering such use or as recommendations for use of such materials in the infringement of any patent.

**FOR MORE INFORMATION,  
PLEASE CONTACT YOUR LOCAL DEALER**

### INSTALLATION DIMENSIONS OF BUSHING WELL

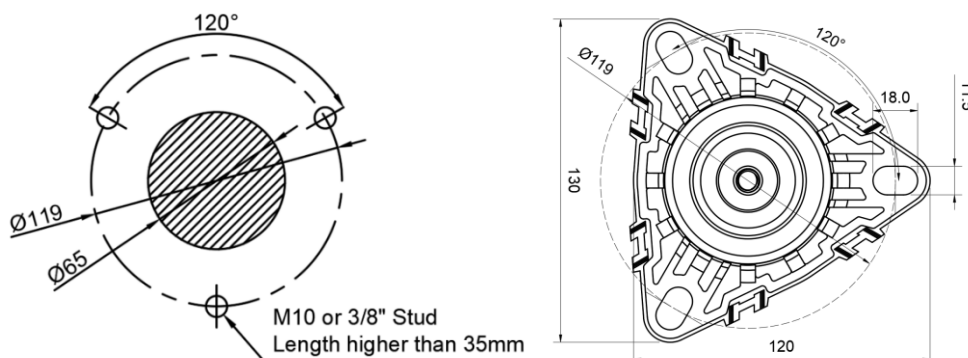

## STUD TYPE DIAGRAM

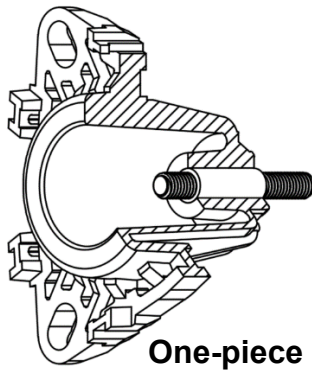

One-piece Stud Type

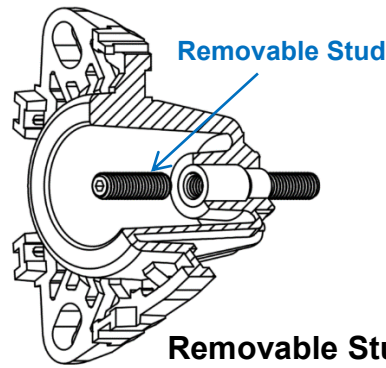

Removable Stud Type

## INSTALLATION

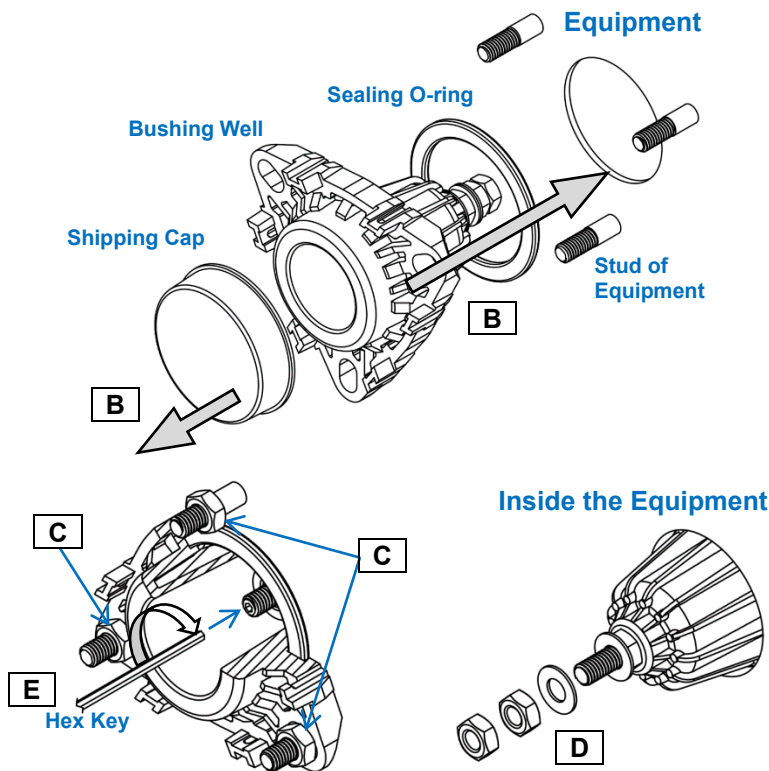

### WARNING:

THE SHIPPING CAP IS NOT SUITABLE AS AN INSULATING CAP FOR ENERGIZED USE.

### STEP 1:

- A. Clean **Bushing Well** and apply **Sealing O-ring**.
- B. Remove the **Shipping Cap** and apply bushing well to equipment.

### STEP 2:

- C. Use socket wrench and tighten exerting nut with 7.5-11Ft-lbs (10-15 Nm) of torque. 3 Nuts must be tightened even on each thread rod of equipment.
- D. Replace 2 nuts and 1 washer of bushing well thread rod and apply the cable with lug. Put washer and nuts and use socket wrench and tighten exerting nut with 7.5-11Ft-lbs (10-15 Nm) of torque.
- E. **Only for Removable Stud Type** **Removable Stud** need to be checked with a 9/64" hex key. The torque must be set to 15-17 ft-lbs (20-23 Nm), excessive torque may cause the removable stud to break or damage.
- F. Replace the Shipping Cap and complete the installation.

### NOTE:

If you need to install a matching product, refer to the installation instructions of the supporting product for the next step.

## REPLACE STUD

### Only for Removable Stud Type

- G. Remove the connected mating product (It could be bushing insert, feed-thru insert or bushing well plug.). Remove the removable stud on the bushing well with a 9/64" hex key.
- H. Check the removed removable stud; if it's broken, check the bottom of the mating product. Remove the broken stud at mating part with a 9/64" hex key.
- J. Install new removable stud and the torque must be set to **15-17 ft-lbs (20-23 Nm)**, excessive torque may cause the removable stud to break or damage.
- K. Install a matching product, refer to the installation instructions of the supporting product for the next step.

