

15/25kV Deadbreak 200A Straight Connector



APPLICATION

The Chardon Deadbreak Straight Connector is a fully shielded and insulated termination for connecting underground cable to transformers, switchgear and other apparatus equipped with deadbreak bushings, junctions, or other deadbreak connectors.

The Chardon Deadbreak Straight meets all the requirements of IEEE standard 386, and is fully interchangeable with competitor's products and mating products that meet IEEE Standard 386.

PRODUCTION TESTS

Tests conducted in accordance with IEEE/ANSI Standard 386.

- / Minimum Corona Voltage Level – 19 kV
- / AC 1 Minute Withstand – 40 kV
- / Test Point Voltage Test

Tests conducted in accordance with Chardon manufacturing process requirements:

- / Physical Inspection
- / Periodic Dissection
- / Periodic X-ray Analysis

VOLTAGE RATINGS

Voltage Class	25 kV
Max. Rating Phase to Ground	15.2 kV
AC 1 Minute Withstand	40 kV
DC 15 Minute Withstand	78 kV
BIL and Full Wave Crest	125 kV
Minimum Corona Voltage Level	19 kV

• Revision Date: 12.20.2024

Chardon Deadbreak Straight Connectors are molded using high quality peroxide – cured insulating and semi-conducting EPDM rubber. All insulating rubber is compounded in house, using Chardon - developed proprietary formulations. Chardon Deadbreak Straight Connectors a copper probe. Combined with the bi-metal compression lug, this ensures a reliable operating connection.

CURRENT RATINGS

Description	Test Parameters
Continuous	200 amps rms
Short Time	• 10,000 amps rms symmetrical for 0.17 s • 3,500 amps rms symmetrical for 3.0 s

DETAILED COMPOSITION OF THE CHARDON DEADBREAK STRAIGHT CONNECTOR

/ CAPACITIVE TEST POINT

Capacitive test point on molded Straight Connector with snap-on cap provides a shielded, hotstick operable means to determine circuit condition.

/ SEMICONDUCTING SHIELD

Precision molded peroxide cured semiconducting shield provides ground shield continuity and meets the requirements of IEEE Standard 592.

/ SEMICONDUCTING INSERT

Precision molded peroxide cured semiconducting insert provides corona-free electrostatic shielding of the compression connector.

/ CABLE ENTRANCE

The sized cable entrance provides an interference fit to maintain a watertight seal.

/ CONDUCTOR CONTACT

Tin plated copper connector ensures reliable electrical connection.

/ DRAIN WIRE TAB

Drain wire tab provide a convenient point to connect drain wire to ensure grounding of the connector shield.

/ INSULATION LAYER

High quality peroxide cured EPDM insulation is mixed and formulated in-house for complete control of rubber characteristics.

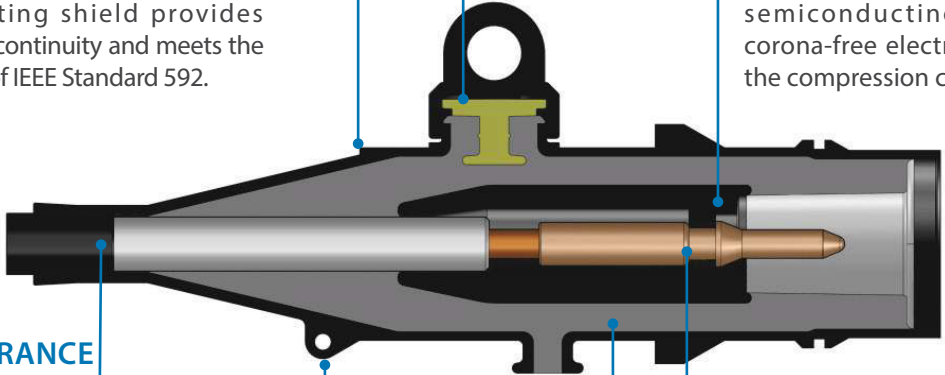

DETAILED COMPOSITION OF THE CHARDON DEADBREAK STRAIGHT CONNECTOR

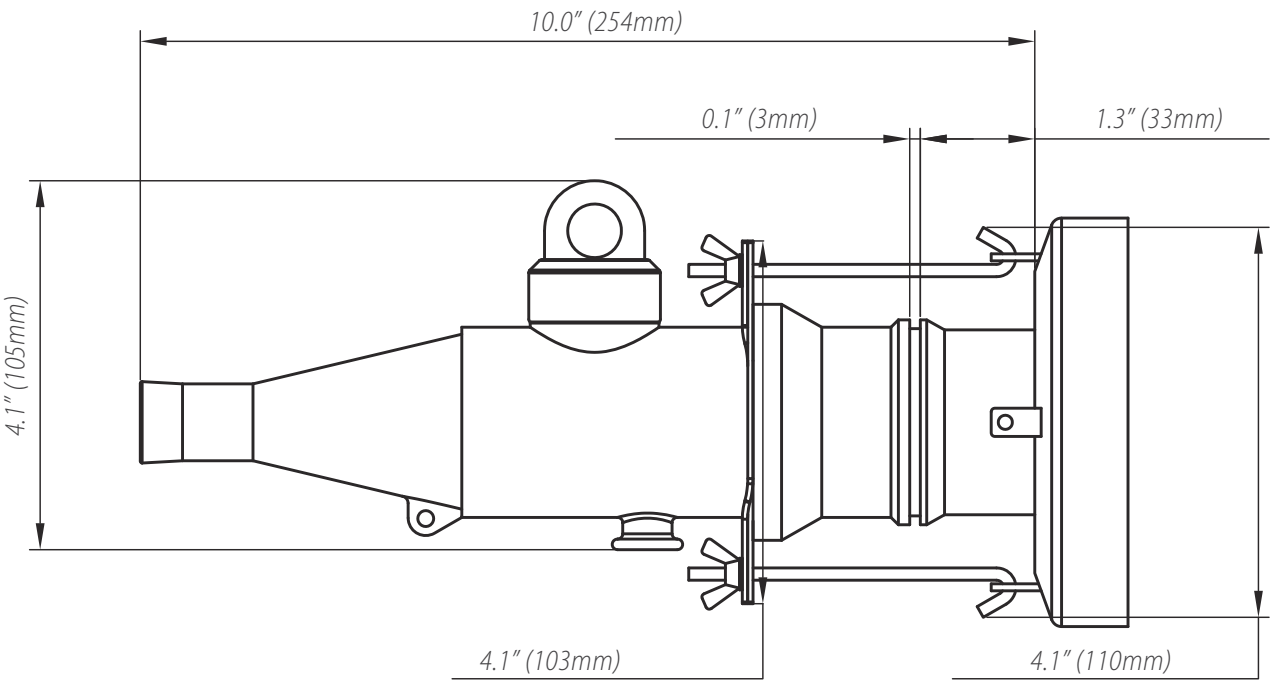

ORDERING INFORMATION

15/25kV Straight Connector

Each kit Contains:

- / Straight Connector body
- / Bi-Metal Compression Lug
- / Silicone Lubricant
- / Copper Probe
- / Bail Assembly
- / Installation Instruction Sheet

To order a Chardon 25kV Deadbreak Straight Connector Kit, follow the steps below:

25-DS200	"W"	"X"	"Y"	"Z"
----------	-----	-----	-----	-----

"W" = Enter **T** if want a Capacitive Test Point

"X" = Cable Range Code (See Cable Range Table)

"Y" = Conductor Code (See Conductor Table)

"Z" = Enter **C** if a Plated Copper Connector is needed

Enter **B** if a Bi-metal Connector is needed

Cable Range Table (Insulation Diameter)

Cable Range Code	Inches	Millimeters
AA	0.508 - 0.685	12.9 - 17.4
A	0.642 - 0.807	16.3 - 20.5
B	0.768 - 0.945	19.5 - 24.0
C	0.906 - 1.106	23.0 - 28.1

Conductor Code Table (Compression Connectors)

CONDUCTOR CODE	Concentric or Compressed		Compact or Solid	
	AWG or kcmil	mm ²	AWG or kcmil	mm ²
01	#6	-	#4	-
02	#4	-	#3	25
03	#3	25	#2	35
04	#2	35	#1	-
05	#1	-	1/0	50
06	1/0	50	2/0	70
07	2/0	70	3/0	-
08	3/0	-	4/0	95
09	4/0	95	250	120
10	250	120	300	-

Example :

To order a standard Chardon 25kV Deadbreak Straight Connector with a cable insulation diameter of 0.990", a 3/0 bi-metal compression connector, and a capacitive test point, order the part number 25-DS200TC08B.



CHARDON TAIWAN CORPORATION

No.37 Min-Chie Road, Tung Lo
Industrial Park, Miao Li, Taiwan 366

Tel : +886-37-984385

Fax : +886-37-984770

www.chardongroup.com • info@chardongroup.com