

## 24/36/42kV 630A CLASS INSULATED CAP INSTALLATION & OPERATING INSTRUCTIONS

### DESCRIPTION:

The CHARDON 630A class deadbreak Insulated Cap meets the full requirements of type C interface per CENELEC EN 50180 and 50181. They are fully screened and fully submersible when mated with the proper bushings and they meet the requirements of IEC 60502-4 and CENELEC HD 629.1 S2.



### KIT CONTENT:

- Insulated Cap
- Silicone Lubricant
- Instruction Sheet
- Paper Towel



### CAUTION:

- The installation of Chardon products must be carried out by qualified technical personnel.
- Contact with energized equipment can cause serious damage and even death.
- Wear appropriate protective equipment.
- Make sure Chardon Accessories are completely dry and in good condition at the time of installation.



### DANGER:

- Do not touch or handle energized products without adequate protective equipment. Errors in the compliance of this instruction can result in damage to the product, serious injuries to people and even death.
- All associated equipment must be de-energized during installation and maintenance.
- The following instructions do not cover details or variables in the change / installation of the product, to prevent contingencies, please contact the team of Chardon technicians if required.

### SAFETY INFORMATION

The instructions in this manual are not intended as a substitute for proper training or adequate experience in the safe operation of the equipment described. Only competent technicians, who are familiar with this equipment should install, operate and service it.

### Warranty

Chardon products are guaranteed for a period of 2 years after their date of purchase, to make this guarantee effective you can come only by presenting a purchase invoice to your authorized Chardon distributor. The warranty will not be valid in the following cases:

1. When the product has been used under conditions other than normal.
2. When the product has not been operated according to the instructions for use.
3. When the product has been altered or repaired by persons not authorized by Chardon.
4. When using components that are not compatible with Chardon accessories.

Inasmuch as CHARDON GROUP, Inc. has no control over the use which others may put the material, it does not guarantee that the same results as those described herein will be obtained, each user of the material should make his own tests to determine the material's suitability for his own particular use. Statements concerning possible uses of the materials described herein are not to be construed as constituting a license under any CHARDON GROUP, inc. patent covering such use or as recommendations for use of such materials in the infringement of any patent.

FOR FURTHER INFORMATION WRITE TO

Chardon Worldwide: [sales@chardongroup.com](mailto:sales@chardongroup.com)

Chardon Mexico: [chardonmx@chardongroup.com](mailto:chardonmx@chardongroup.com)

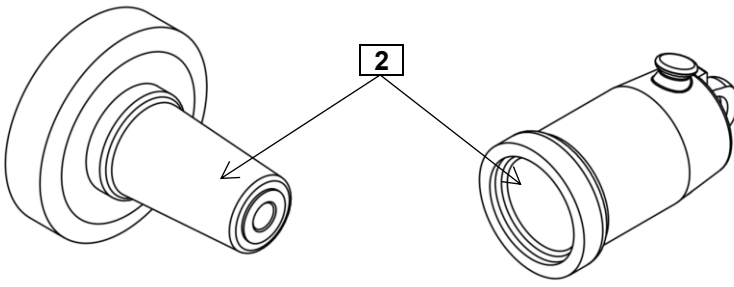

**STEP 1:**

- a) Ensure the Insulated Cap has the same voltage rating as the equipment system.
- b) Ensure all cables and equipment are properly de-energized.

**STEP 2:**

Clean the interfaces of the insulated cap and apparatus bushing and lubricate them by using the Silicone lubricant provided in the kit.

**NOTE:**  
Do not substitute other lubricants for those provided.

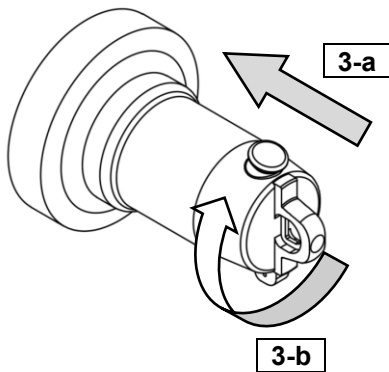

**STEP 3:**

- a) Push insulated cap onto mating apparatus interface.
- b) Turn insulated cap to make a threaded connection. Continue turning the insulated cap until tight.

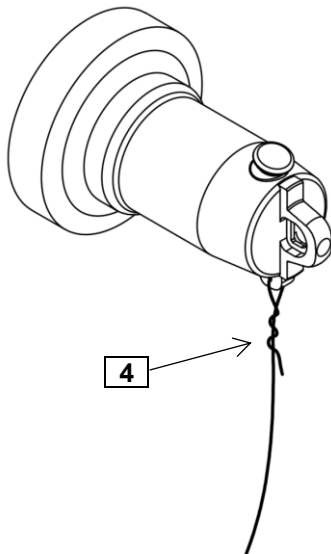

**STEP 4:**

Attach the grounding wire to the system ground.