

(ANSI) 15/25/35kV 200A INTEGRAL BUSHING WELL

INSTALLATION INSTRUCTIONS

DANGER & IMPORTANT:

1. All apparatus must be de-energized during installation or removal of part(s). Make sure the products specification is in accord with the applied system.
2. Check contents of package to ensure they are complete and undamaged. Check all components to ensure proper fit with cable and/or mating products.
3. All apparatus must be installed and operated in accordance with individual user, local, and national work rules. These instructions do not attempt to provide for every possible contingency.
1. Read entire installation instructions before starting. Have all required tools at hand and maintain cleanliness throughout the procedure.

Required tools: Monkey spanner, T-type deep socket wrench、Imperial 9/64 Allen wrench

Installation Dimensions And Drawing of Mounting Flange:

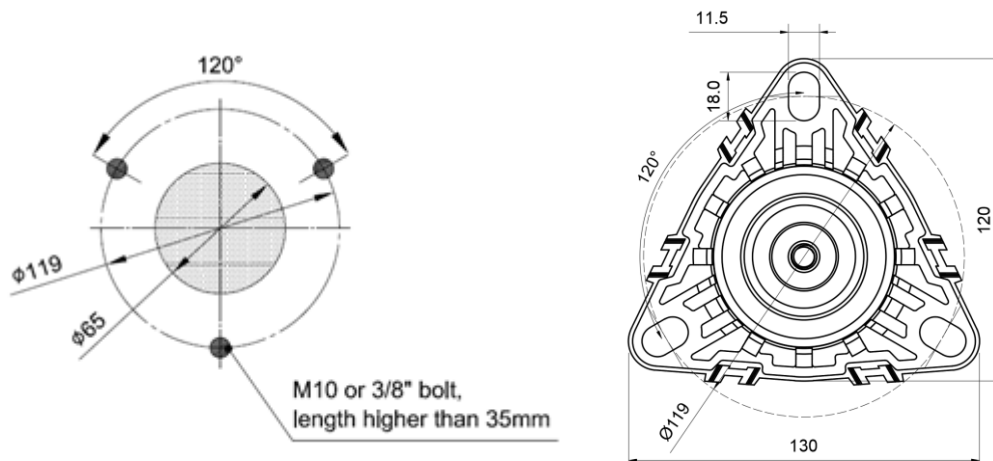

Bushing Well Body Style Profile Diagram:

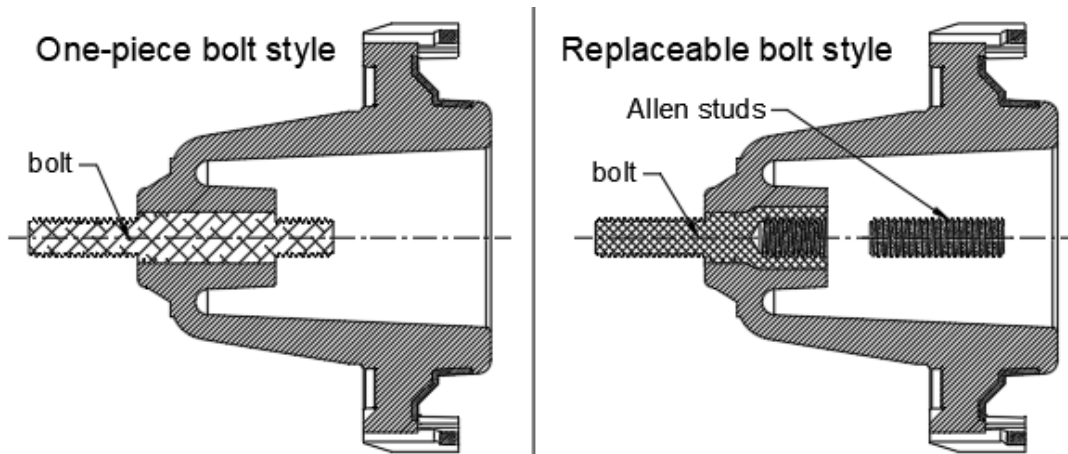

INSTALLATION PROCEDURE:

STEP 1

- Clean Bushing Well and apply Sealing O-ring.

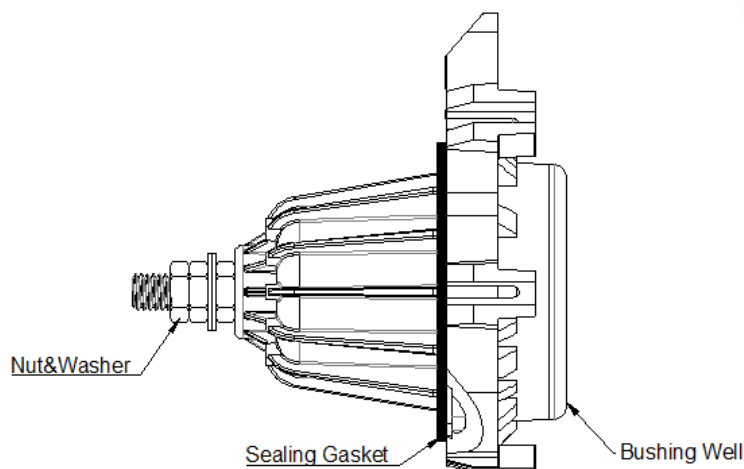

STEP 2

- Remove the Shipping Cap and apply Bushing Well to equipment.
- Apply Mounting Flange. Use socket wrench and tighten exerting nut with **7.5-11ft-lbs 【10-15N.m】** of torque.
- Nuts must be tightened evenly on each thread rod of equipment.

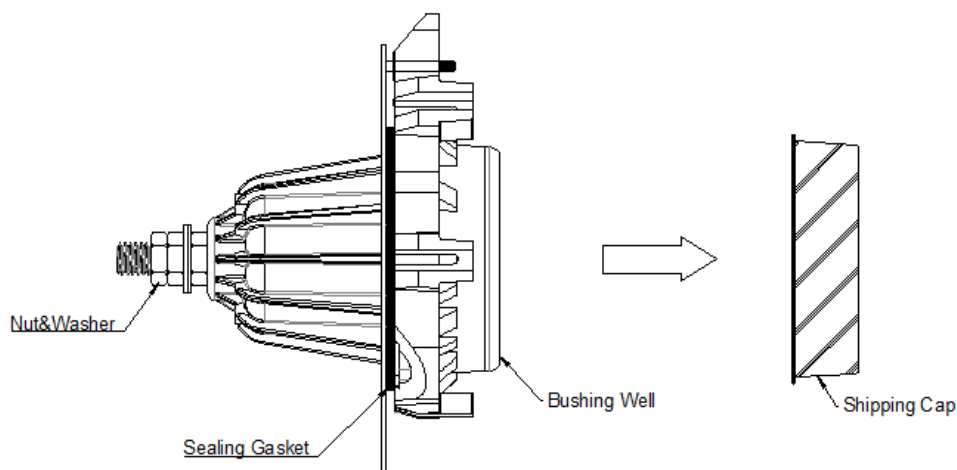

STEP 3

- Remove 2 nuts and 1 washer from the Bushing Well thread rod and apply the cable with lug. Put back 2 nuts and 1 washer and use socket wrench to tighten the nut with **7.5-11ft-lbs 【10-15N.m】** of torque.

STEP 4

● Replaceable bolt Bushing Well need to be inserted and twisted with a 9/64 Allen wrench to check whether the Allen studs are tightened.

● The torque force must be set to **15-17ft-lbs 【20-23 N·m】**, excessive torque may cause the Allen stud to break or damage

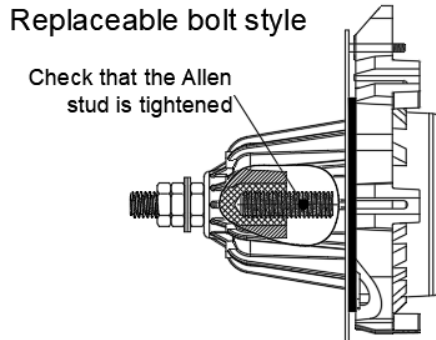

STEP 5

● Clean the operating interface. Uniformly apply lubricant provided to the bushing operating interface. Apply the Bushing Insert or Rotatable Feed-Thru Insert or Bushing well insulated plug to operating interface.

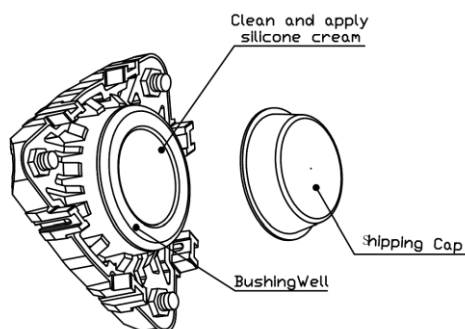

WARNING: THE SHIPPING CAP IS NOT SUITABLE AS AN BUSHING WELL INSULATED PLUG FOR ENERGIZED USE.

If the Allen stud in the replaceable bolt casing well is broken, the Allen stud in the casing well can be used with single-way or double-way after replacement, and the specific operation steps are as follows :

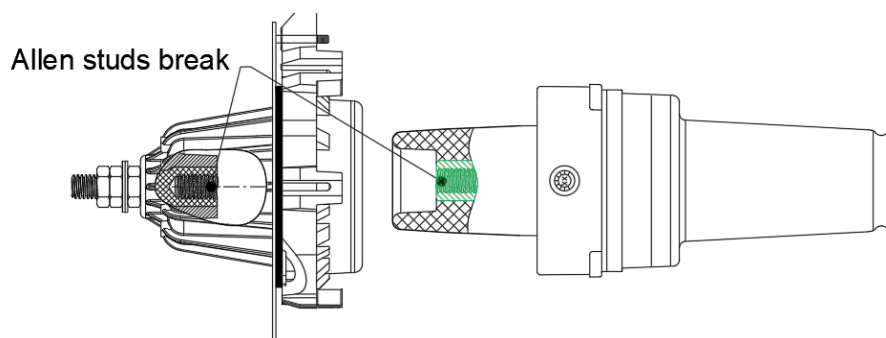

STEP 1

- Remove the connected Rotatable Feed-Thru Insert, and use an Allen wrench to disassemble the Allen stud that has been broken in the Rotatable Feed-Thru Insert. Clean Rotatable Feed-Thru Insert for later use after confirming that it is not damaged.

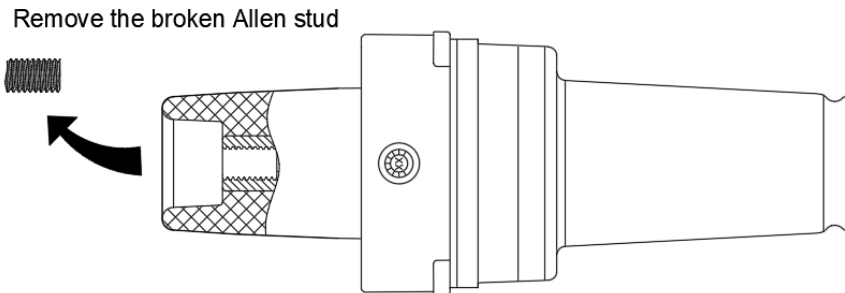

STEP 2

- Use an Allen wrench to remove the broken Allen stud from the replaceable bolt Bushing Well, then insert the Allen key completely into the hexagonal hole of the intact Allen Stud, and finally tighten the Allen Stud within Bushing Well, the torque must be set to **15-17ft-lbs 【20 -23 N·m】**, excessive torque may cause the Allen Stud to break or damage again.

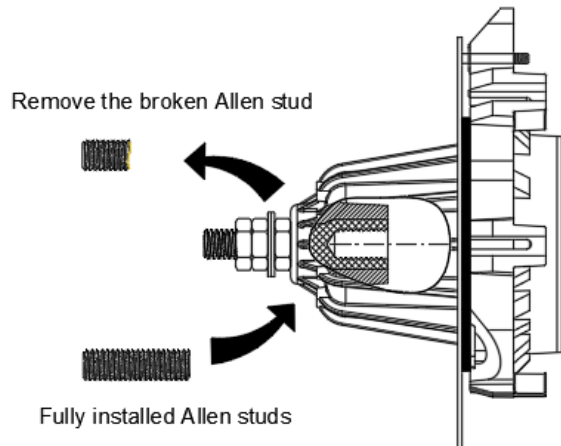

STEP 3

- Perform the installation **STEP 5** above.

Inasmuch as CHARDON GROUP, Inc. has no control over the use which others may put the material, it does not guarantee that the same results as those described herein will be obtained, Each user of the material should make his own tests to determine the material's suitability for his own particular use. Statements concerning possible uses of the materials described herein are not to be construed as constituting a license under any CHARDON GROUP, inc. patent covering such use or as recommendations for use of such materials in the infringement of any patent.

FOR FURTHER INFORMATION WRITE TO



sales@chardongroup.com