

# **IEC Separable Connectors** **36 kV, 630A**

**Front T-Body / Coupling (Rear) T-Body Connector**



## APPLICATION

Chardon Front T-Body / Coupling (Rear) T-Body Connectors are fully screened and fully submersible when mated with proper bushings or plugs. The products are used to terminate polymeric cable to dead front apparatus such as transformers, switchgear, and other equipment. They can be used for 36kV applications.

The Chardon T-body Connectors are suitable for indoor or outdoor applications, and are able to be used for all polymeric cable types (XLPE, ETP, etc.) with copper or aluminum conductors. The design is especially suited for the harsh off-shore or wind farm environment, where long runs and large cable sizes are needed.

## KEY FEATURES

- / Provides a fully shielded and submersible connection when mated with the proper bushing or plug.
- / Type "C" 630A Interface in accordance with EN 50181-2010.
- / Mounting can be vertical, horizontal, or any angle in between.
- / No minimum phase clearance requirements.
- / 100% electrical tested at factory.

## PRODUCT RATINGS

Maximum Voltage Class (U <sub>m</sub> )	36 kV
AC 5 Minute Withstand	81 kV
DC 15 Minute Voltage Withstand	72 kV
Minimum Corona Voltage Level	30 kV < 10pC
BIL and Full Wave Crest (Impulse)	170 kV
Thermal Short Circuit (Conductor, 2 sec.)	23 kA
Dynamic Short Circuit	82 kA
Continuous Current	630 A

## PRODUCTION TESTS

Tests conducted in accordance with IEC 60502-4.

- / Minimum Corona Voltage Level – 30 kV ≤ 3pC
- / AC 5 Minute Withstand – 81 kV

• 36FDT630-36RDT630-121322-REV04

## DETAILED COMPOSITION OF THE CHARDON 36 KV FRONT T-BODY CONNECTOR





**DETAILED COMPOSITION OF THE CHARDON  
36 KV FRONT T-BODY CONNECTOR**

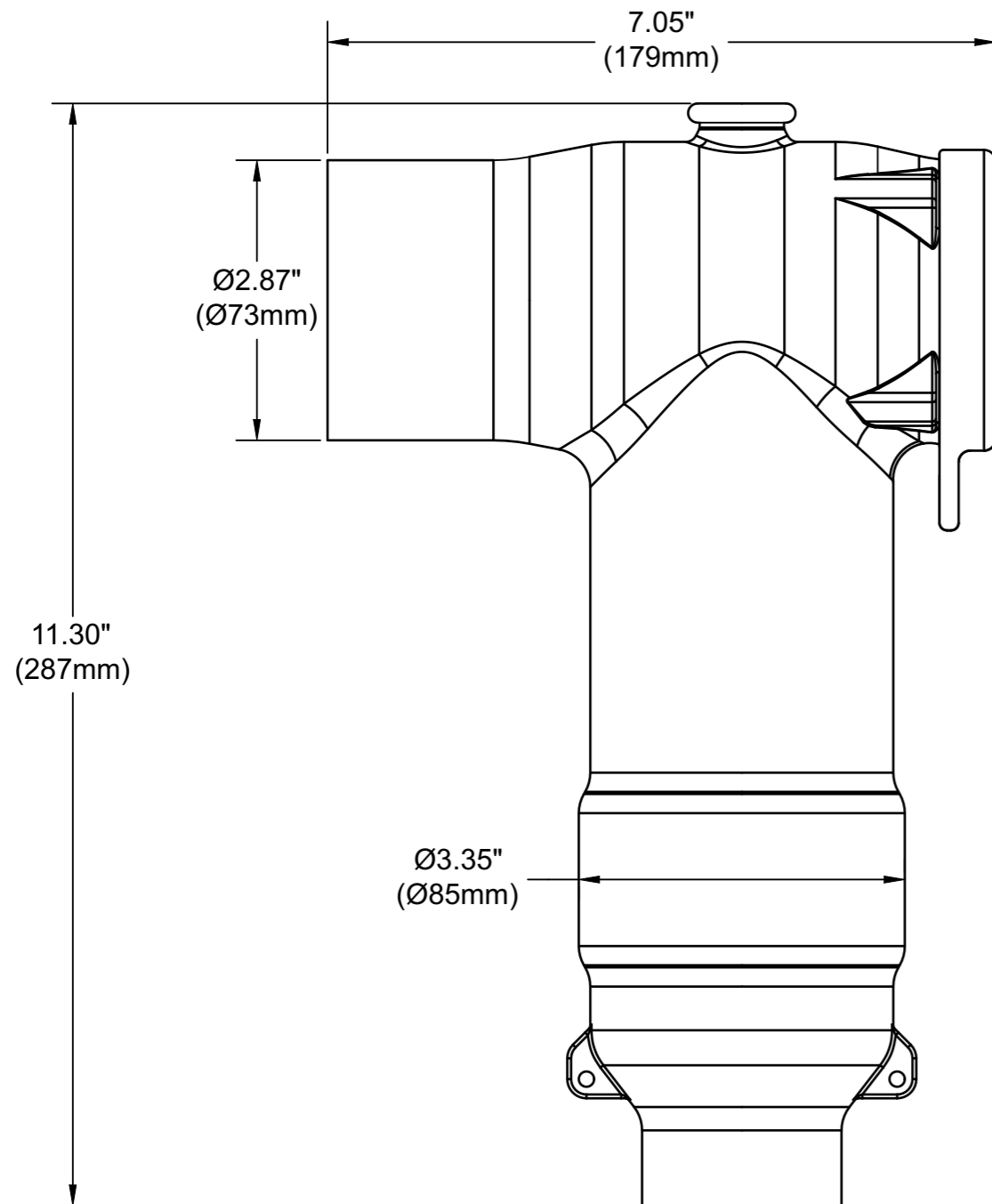

**DETAILED COMPOSITION OF THE CHARDON  
36 KV COUPLING (REAR) T-BODY CONNECTOR**



## DETAILED COMPOSITION OF THE CHARDON 36 KV COUPLING (REAR) T-BODY CONNECTOR

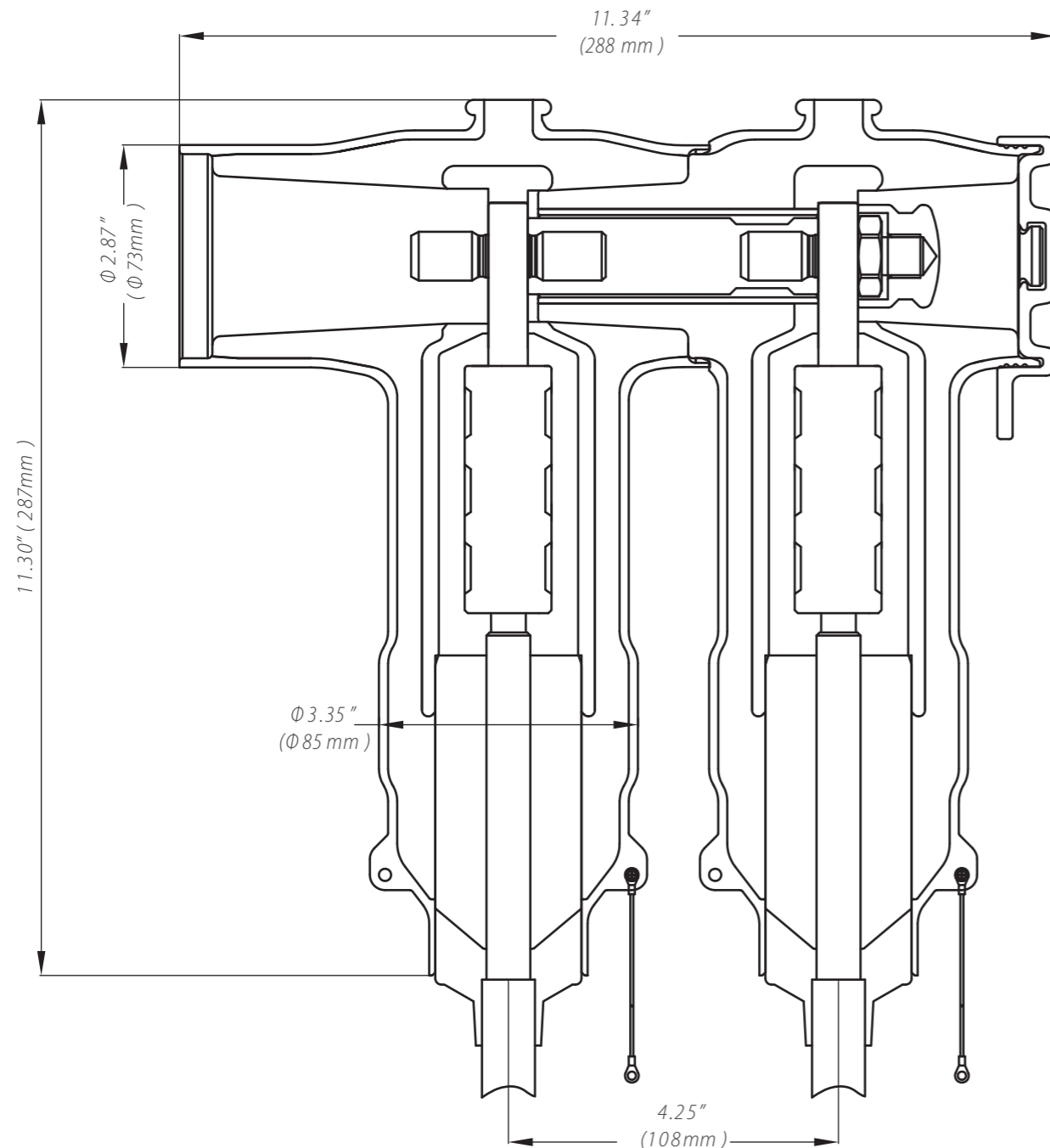

## ORDERING INFORMATION

36-	---	630-	-	---	-
	<b>STEP1</b>		<b>STEP2</b>	<b>STEP3</b>	<b>STEP4</b>

### STEP1

#### Selection of Front / Rear T-body

Code	
FDT	Front T-body
RDT	Coupling (Rear) T-body

### STEP2

#### Selection of Cable Insulation Dimension

Range Code	mm (inch)
LA	15.5 - 19.0 (0.610 - 0.748)
LB	18.0 - 21.0 (0.709 - 0.827)
LC	20.0 - 23.0 (0.787 - 0.905)
LD	22.0 - 25.0 (0.866 - 0.984)
LE	24.0 - 27.0 (0.945 - 1.063)
LF	26.0 - 29.0 (1.024 - 1.142)
LG	28.0 - 32.0 (1.102 - 1.260)
LH	31.0 - 34.0 (1.220 - 1.339)
LI	33.0 - 37.0 (1.299 - 1.457)
LJ	36.0 - 39.0 (1.417 - 1.535)
LK	38.0 - 42.0 (1.496 - 1.654)

### STEP3

#### Selection of Conductor Size

Conductor Code	Conductor Size (mm <sup>2</sup> )
25	25
35	35
50	50
70	70
95	95
120	120
150	150
185	185
240	240
300	300
400	400

### STEP4

#### Selection of Compression Connector Material

Code	
B	Bi-metal (Al & Cu)
C	Copper

#### Ordering Example:

For a CHARDON 36 kV Front T-body with cable insulation outer dimension of 33.9 mm and a conductor size of 185 mm<sup>2</sup> with copper compression connector, the part number would be as follows.

36-	FDT	630	LH	185	C
-----	-----	-----	----	-----	---

If a shear bolt connector is selected in this kit, the part number would be 36-FDT630LH-SBC-B-150-240/2.

36-	FDT	630	LH	SBC-B-150-240/2
-----	-----	-----	----	-----------------

#### Chardon Shear Bolt Connector

Example:

ForaShear Bolt Connector with a conductor Range between 20-50 mm<sup>2</sup>, the part number would be : SBC-B-25-50/1.

CATALOG NO.	Conductor Range(mm <sup>2</sup> )
SBC-B-25-50/1	25 - 50
SBC-B-70-95/1	70 - 95
SBC-B-70-120/2	70 - 120
SBC-B-150-240/2	150 - 240
SBC-B-300-400/3	300 - 400





**CHARDON TAIWAN CORPORATION**

No.37 Min-Chie Road, Tung Lo  
Industrial Park, Miao Li, Taiwan 366

Tel : +886-37-984385

Fax : +886-37-984770

[www.chardongroup.com](http://www.chardongroup.com) • [info@chardongroup.com](mailto:info@chardongroup.com)